

RETAIN 1909 + EXPANSION SITE

LANDSCAPE, ATHLETICS, AND PUBLIC SPACE

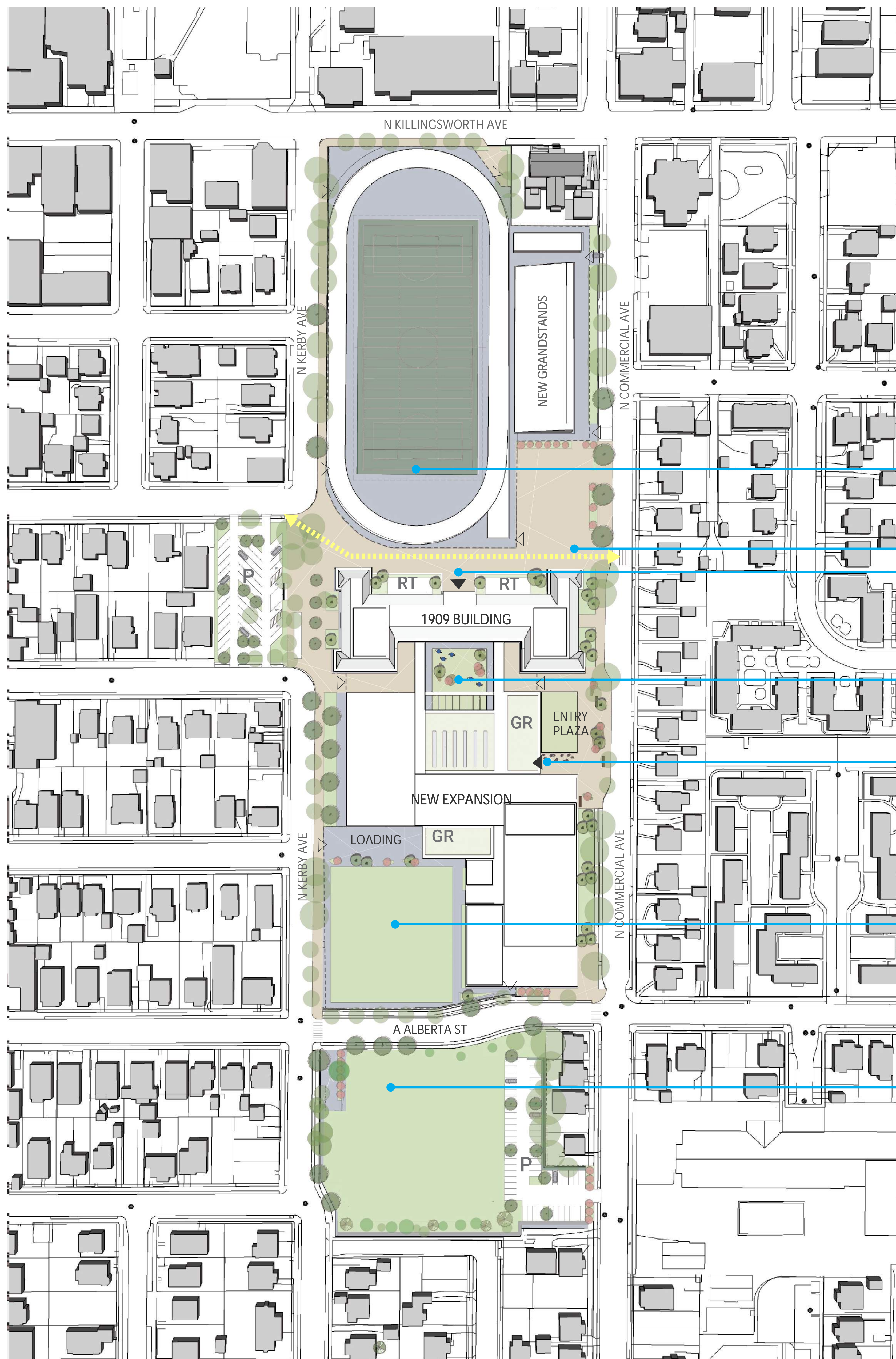

Site Design for Students and the JHS Community

- Existing track to remain with improved facilities and features
- Cross-Block walk for public use outside of school hours
- Plazas for places of memory
- Community and student gathering areas
- Preservation of perimeter trees where possible
- New playfields for student and community use - both regulation and practice sizes

EXISTING FIELD TO REMAIN

CROSS-BLOCK WALK
EXISTING STAIR PROPOSED TO BE REMOVED FOR UNIVERSAL ACCESS. DESIGN IS PENDING.

COMMONS

MAIN ENTRY

PLAYFIELD 1

PLAYFIELD 2

SITE CONCEPT PLAN



LEGEND

◀ BUILDING ENTRY
◁ GATE

P PARKING
GR GREEN ROOF
RT ROOF TERRACE

NEW TREES

EXISTING TREES TO REMAIN

--- FENCE

PLAZA PAVEMENT

STUDENT SPACES + LANDSCAPE IDEAS

ATHLETICS AND SITE DESIGN

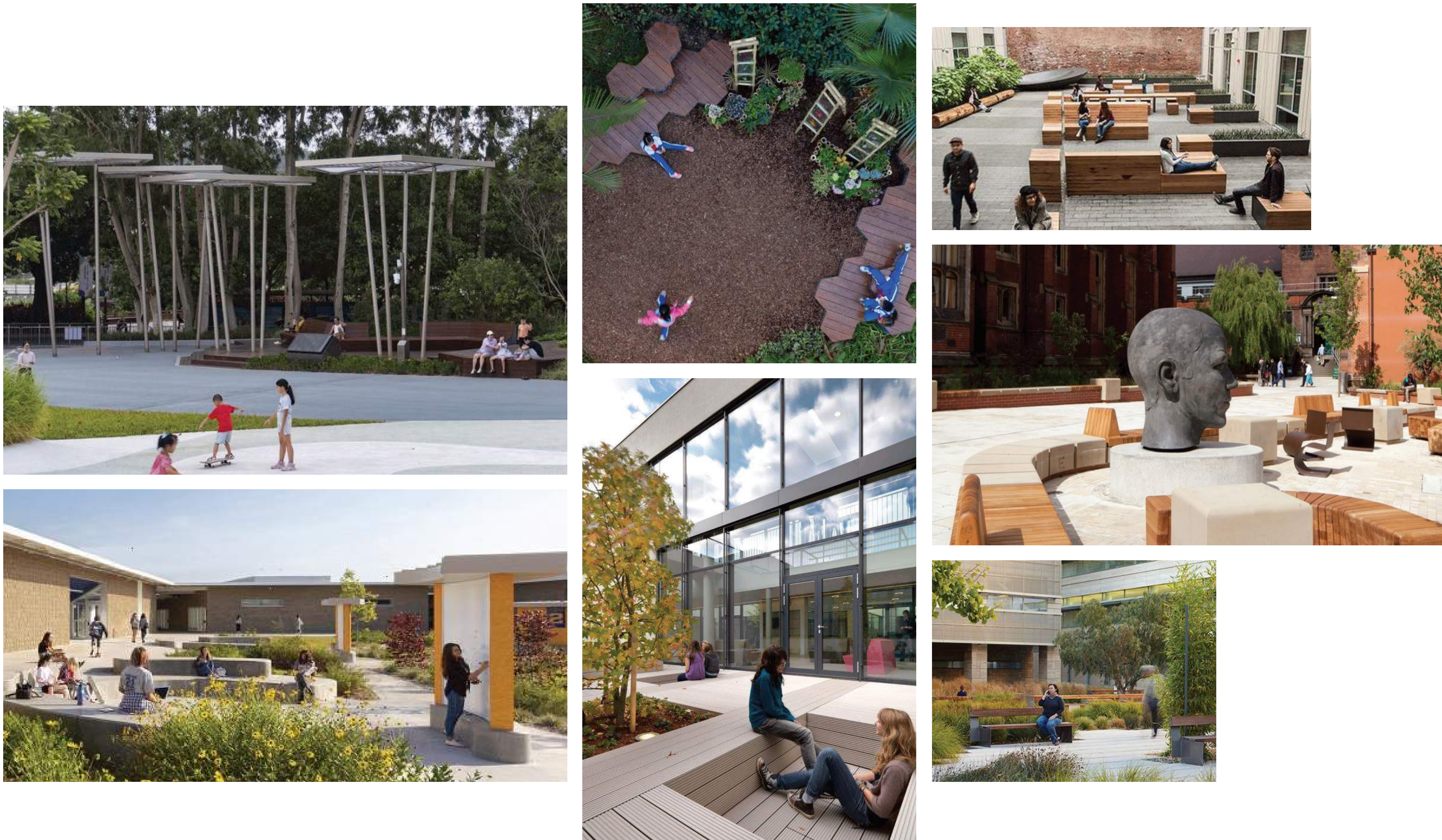

STUDENT OUTDOOR SPACE

Covered walkways + seating

- Four seasons use of outdoor spaces
- Safety, health, + fun

Multi-use spaces

- Gathering, eating, studying
- Athletic event spill-out space
- Arts event secondary use spaces

Community Use of Public Areas

- Outdoor places of memory accessible outside fenced perimeter
- Community gathering space always public
- Resources inside the school perimeter available for community use

COMMONS + ENTRY PLAZA



MULTI-SPORT FIELDS

Practice fields for students and Community

- All playfields will be designed to respond to teacher and practice requirements.
- Additional South Lot uses may include parking, community gardens, and stormwater remediation.

HALF FOOTBALL FIELD (HS)
FAST PITCH (180')
SOCCER (U-12)

ATHLETIC FIELD OPTIONS